

TAKE DOWN DERBY SLED MARK 2, MOD 1 2004  
 DAVID FAYDENLUND  
 CREW/TROOP 27

SHEET 2

NTS 1" ≈ 1'

REAR ASSEMBLY FROM INSIDE SLED

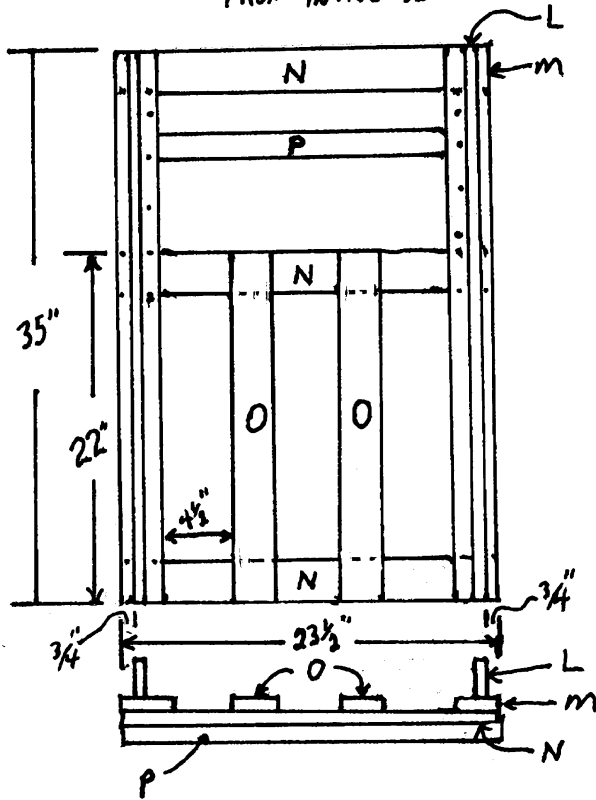

ASSEMBLY DETAIL

BOTTOM DECK TO SIDES  
 BOLT DOES NOT GO THROUGH J

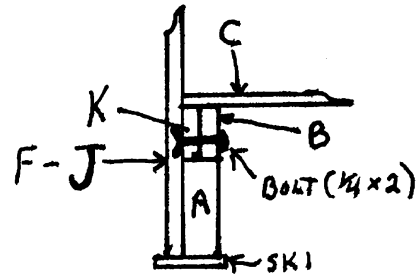

REAR ASSEMBLY TO SIDES  
 RIGHT SIDE



HARNESS NOTES - EXCEPT ON FLAT GROUND, SLEDS NEED 2 HARNESSES. 1 FOR PULLING, ONE FOR CONTROLLING DESCENT ON DOWNHILL RUNS. THERE ARE TWO MAIN HARNESS TYPES, FAN FOR OPEN COUNTRY, LINEAR FOR TRAILS.

FAN

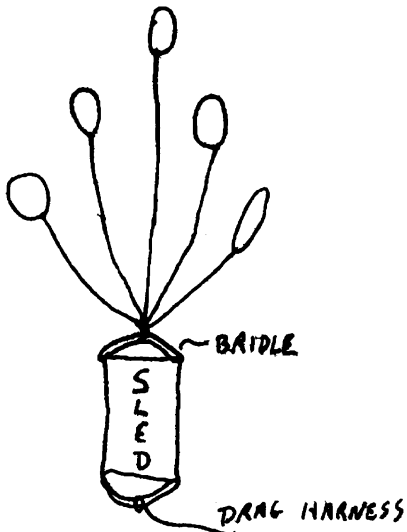

LINEAR

